

# Application for Development Approval



Owner(s) Details			
Name	Allan Whitehouse	ABN (if applicable)	
Address	53 Forrest Street, Kellerberrin		
Phone		Mobile	0478632038
Email	gju0904@gmail.com		
Contact Person for Correspondence	Allan Whitehouse		
Preferred Method of Contact:	Letter <input type="checkbox"/>	Phone <input type="checkbox"/>	Email <input checked="" type="checkbox"/>
Signature		Date	29-01-2024
Signature		Date	
<i>The signature of the owner(s) is required on all applications. This application will not proceed without those signatures. For the purposes of signing this application an owner includes the persons referred to in the Planning and Development (Local Planning Schemes) Regulations 2015 Schedule 2 clause 52(2)</i>			

Applicant Details (if different from Owner)			
Name		ABN (if applicable)	
Address			
Phone		Mobile	
Email			
Contact Person for Correspondence			
Preferred Method of Contact:	Letter <input type="checkbox"/>	Phone <input type="checkbox"/>	Email <input type="checkbox"/>
The information and plans provided with this application may be made available by the Local Government for public viewing in connection with the application.		Yes <input type="checkbox"/>	No <input type="checkbox"/>
Signature		Date	

Property Details			
Location	53 Forrest Street, Kellerberrin	Folio	
Lot	4	House Number	53
Street Name	Forrest	Suburb	Kellerberrin
Diagram or Plan Number		Nearest Intersection	Forrest and Scott St.
Cert. of Title Vol. Number		Title encumbrances (eg; easement, restrictive covenants)	

<b>Details of Proposed Development</b>			
<b>Nature of Development</b>	<b>Works</b> <input type="checkbox"/>	<b>Use</b> <input type="checkbox"/>	<b>Works &amp; Use</b> <input type="checkbox"/>
<b>Is an exemption from development claimed for part of the development</b>			<b>Yes</b> <input type="checkbox"/> <b>No</b> <input type="checkbox"/>
<b>If yes, is the exemption for</b>	<b>Works</b> <input type="checkbox"/>	<b>Use</b> <input type="checkbox"/>	
<b>Description of proposed works and/or land use</b>		Garden feature, incidental structure	
Structure to support a climbing plant, commentary provided as attached.			
- <u>Structure</u> diagram provided as Attachment One			
- Site layout provided as Attachment Two			
<b>Description of exemption claimed (if relevant)</b>			
<b>Nature of any existing buildings and/or land use</b>		Residential	
<b>Approx. cost of proposed development</b>		\$100	
<b>Estimated time of completion</b>		1 hour	

← **OFFICE USE ONLY** →

**Administration Staff**

<b>Record Number</b>		<b>Date Received</b>	
<b>Officer Name</b>		<b>Officer Signature</b>	

<b>Application Fees</b>	\$	<b>Receipt Number</b>		<b>Date Paid</b>	
-------------------------	----	-----------------------	--	------------------	--

**Town Planner**

<b>Approval</b>	<b>Yes</b> <input type="checkbox"/>	<b>No</b> <input type="checkbox"/>	<b>Date</b>	
<b>Officer Name</b>		<b>Officer Signature</b>		
<b>Correspondence Sent</b>	<b>Letter</b> <input type="checkbox"/>	<b>Phone</b> <input type="checkbox"/>	<b>Email</b> <input type="checkbox"/>	<b>Date</b>

## Application for Development of Incidental Structure

Allan Whitehouse

Lot 4, Number 53 Forrest Street, Kellerberrin

### Introduction

The garden structure is an incidental structure, as it is supplementary to our buildings, performing the function of a support or trellis for a climbing plant and is ornamental as a part of our garden landscaping. The structure:

- is not attached to any building on the site;
- does not affect the way other buildings comply with applicable building standards;
- does not obscure any sight lines to the roadways or crossovers; and
- is set well within the lot boundaries.

### Installation

The three (3) footings for the structure are:

- installed in a clean cut excavation free from loose earth, tree roots, mud and debris;
- in the natural previously undisturbed and compacted clay soil common to the area;
- in a flat site, with clearance to enable drainage rather than pooling of water and does not result in surface water being diverted to buildings on the site;
- tapered slightly from base to top, thicker at the bottom than at the ground surface level, and are generally square at the surface;
- installed using cement stated by the manufacturer as complying with Australian Standards, using 20 millimetre aggregate, and mixed to the manufacturer's instructions to be fit for this purpose, and left to cure for fourteen (14) days prior to erecting the structure;
- mainly concrete with the approximate dimensions of 90 centimetres (cm) depth and 30 – 35 cm square at the surface which was compacted using rodding and spading ; and
- include a galvanised steel anchor posts that have the dimensions of 50 mm x 50 mm x 5 mm gauge steel, 110 cm total length, with 83 cm in the concrete and 27 cm ( 24.5 %) of their height above ground.

### Structure

The structure:

- does not support any floor or roof area;
- is set plumb with each of the three (3) legs bolted to a steel anchor post set in the concrete footings;
- has three (3) legs in a triangle formation;
- is made from hot dip galvanised steel of 50 mm x 55 mm x 3 mm steel which provides resistance against corrosion even in harsh environments, and 3 mm steel wire bracings;
- is bolted with 10 mm thick bolts; and
- total width of the circle of blades is 240 cm.

### Estimated value of building work

\$100

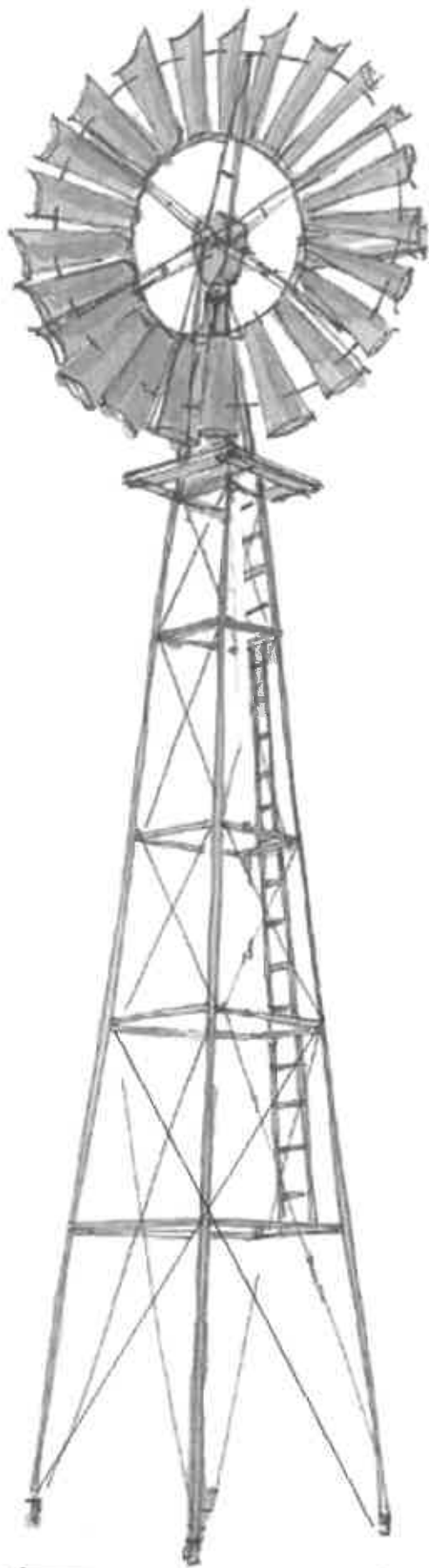

Height: 8 metres



Width: 1.5 metres at bottom

Widest point for blades: 2.4 metres

**Applicant:** Allan Whitehouse

**Address:** LOT 4 / 53 Forrest Street, Kellerberrin

**Development:** Incidental Structure

## Footings and Anchor Stirrups

One for each tower leg

Concrete block 30 cm wide at ground level

Steel galvanised anchor post:

27 cm above ground surface

83 cm encased in the concrete block.

Overall length 110 cm

Concrete block 90 cm depth/height

Concrete block approximately 40 cm wide at bottom

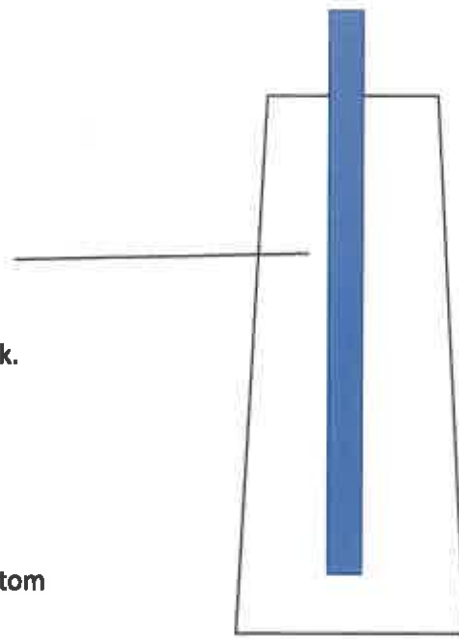

Site drawing

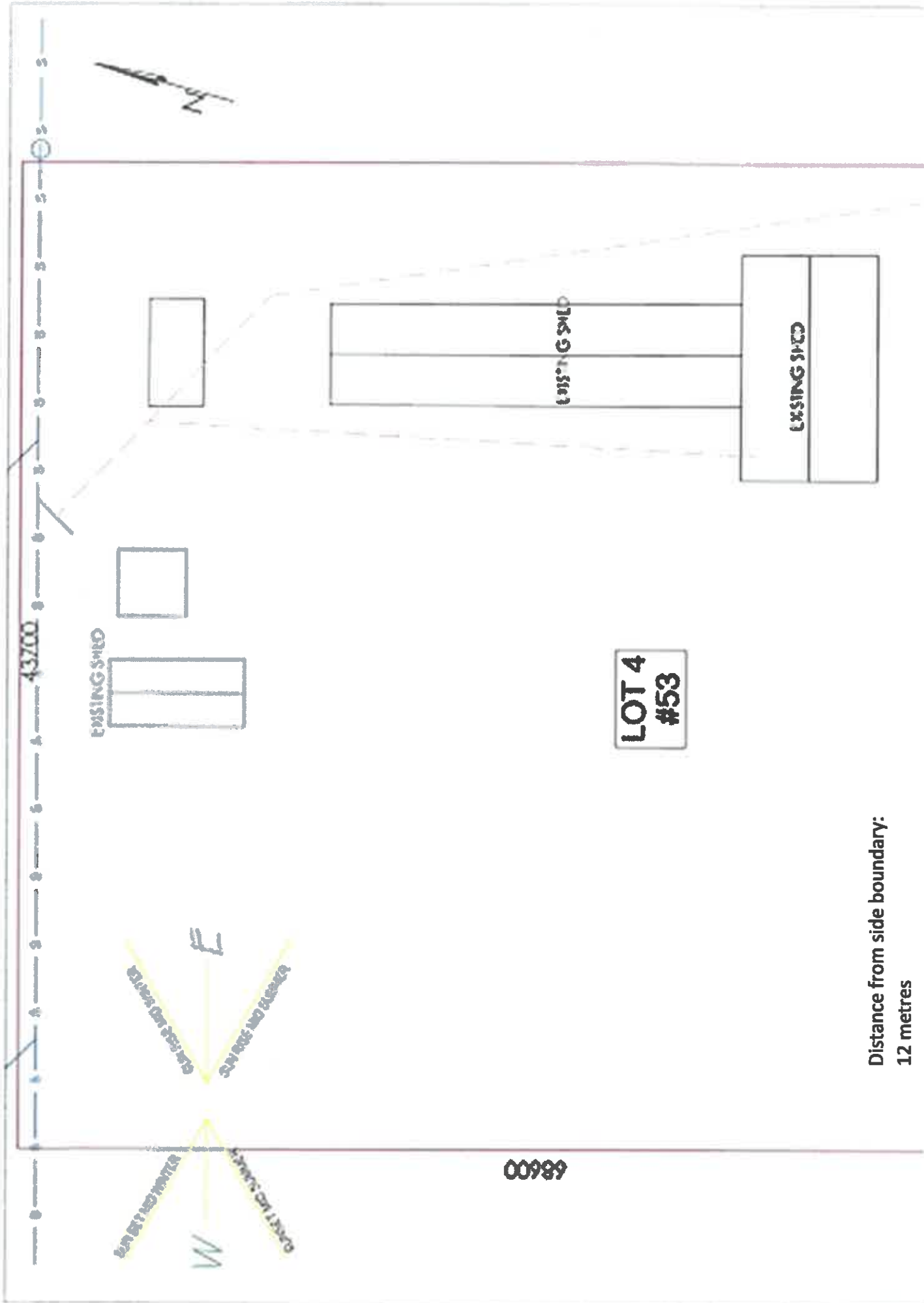

Distance from side boundary:  
12 metres